



studio, llc
865.769.8075 v.
865.769.8076 f.



Date: December 19, 2017

File Name: Morristown_a2.1

Project No: 2017-186

Drawing Title: Floor Plan

Revisions:

A New Retail Facility:
Cherokee Crossing Phase II
140 Hatfield Drive
Morristown, TN 37814

Sheet No.

a2.1

PARTITION LEGEND	
GENERAL	
(SA)	NON-RATED PARTITION 3/8" STL. STUDS AT 16" O.C. - 1/2" O.C. (MAX) WITH ONE (1) LAYER OF 5/8" GYP. BOARD ON EACH SIDE. EXTEND PARTITION TO 6" ABOVE CEILING. PROVIDE 6" STUDS WHERE NOTED ON DRAWINGS OR PARTITION TYPES LISTED BELOW. "SA" INDICATES WALL TO RECEIVE SOUND ATTENUATION BLANKETS.
	INTERIOR OR EXTERIOR WALL 8" CMU WALL. REFERENCE WALL SECTIONS FOR SIZE LOCATIONS. VOID CELLS TO RECEIVE FOAM INSULATION - CORE FILL 300 FOAM OR EQUAL, R-9.5 (MIN).
RATED	
(SA)	3/8" STL. STUDS (MIN. 22 GAUGE) (SEE PLAN) AT 16" O.C. - 24" O.C. (MAX) W/ ONE (1) LAYER OF 5/8" "TIRE CORE TYPE" GYPSUM BOARD ON EACH SIDE. EXTEND PARTITION TO DECK AND SEAL EACH LAYER OF GYPSUM BOARD TO DECK W/ APPROVED FIRESTOP SEALANT. "SA" INDICATES WALLS TO RECEIVE SOUND ATTENUATION BLANKETS/MINERAL BATT INSULATION.
GENERAL NOTES	
1. GYP. BOARD AT RESTROOMS TO BE MOISTURE RESISTANT.	
2. SEE FINISH SCHEDULE & INTERIOR ELEVATIONS FOR FINISH MATERIAL DESIGNATION AT RESTROOMS.	
3. SEE INTERIOR ELEVATIONS FOR HEIGHTS OF FINISHES.	
4. PARTITION & FINISH MATERIAL TO EXTEND 1" ABOVE CEILING OR TO 10'-0" AFF IN LOCATIONS WITHOUT CEILING, UNLESS OTHERWISE NOTED.	
5. ALL GYP. BOARD JOINTS TO BE TAPPED & SEALED.	
SPECIFIC DESIGNATIONS	
1	PARTITION TYPE A: CMU WALL. SEE SPECIFIC WALL FINISH BELOW. SEE GENERAL NOTES ABOVE.
2	CMU WALL.
3	CMU WALL INTERIOR TO RECEIVE 1/2" METAL HAT CHANNELS @ 16" O.C. W/ 5/8" GYP. BOARD.
PARTITION TYPE B:	
4	5/8" METAL STUDS @ 16" O.C. SEE SPECIFIC WALL FINISH BELOW. SEE GENERAL NOTES ABOVE.
5	5/8" METAL STUD WALL W/ 5/8" GYP. BOARD ON BOTH SIDES REF. DETAIL 310-3.3.
6	5/8" METAL STUD WALL (MIN. 22 GAUGE) W/ 5/8" GYP. BOARD ON BOTH SIDES. WALL TO EXTEND TO DECK. REF. DETAIL 210-3.3.
7	3/8" (MIN. 22 GAUGE) METAL STUD WALL W/ 5/8" GYP. BOARD ON BOTH SIDES. WALL TO EXTEND TO DECK. RESTROOM SIDE OF WALL TO RECEIVE ADDITIONAL 3/8" METAL STUDS @ 16" O.C. TO BE HELD OFF OF WALL W/ 5/8" GYP. BOARD ON TOP. SEE ONLY REF. DETAIL 110-3.3.
PARTITION TYPE C: REFERENCE WALL SECTIONS FOR SPECIFIC DESIGNATIONS.	
FLOOR PLAN GENERAL NOTES	
1. THIS PLAN IS INTENDED TO SHOW OVERALL LAYOUT OF MODULES. EXACT LAYOUT MAY VARY SLIGHTLY AS DIRECTED BY ARCHITECTURAL SUPPLEMENTAL INSTRUCTIONS OF INTERIOR FINISHES, SWITCHES, ACCESSORIES, ETC.	
2. VERIFY EXACT LOCATION OF WATER SERVICE ENTRANCE, ELECTRICAL PANEL AND TELEPHONE BOARD IN EACH MODULE. IF TENANT DRAWINGS ARE NOT AVAILABLE, VERIFY ROUGH-IN LOCATION WITH OWNER (TYP).	
3. PROVIDE FIRE EXTINGUISHERS IN EACH MODULE. COORDINATE EXACT LOCATION WITH FIRE MAINTENANCE.	
NOTE:	
1. REF. #2.0 FOR FINISH SCHEDULE.	
2. REF. #2.4 FOR GUTTER & DOWNSPOUT LOCATIONS, SIZINGS.	

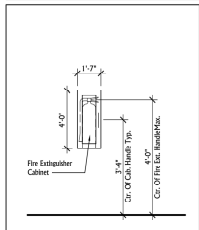

Fire Extinguisher Cabinet
2 FIRE EXT. CABINET
SCALE: 1/8" = 1'-0"

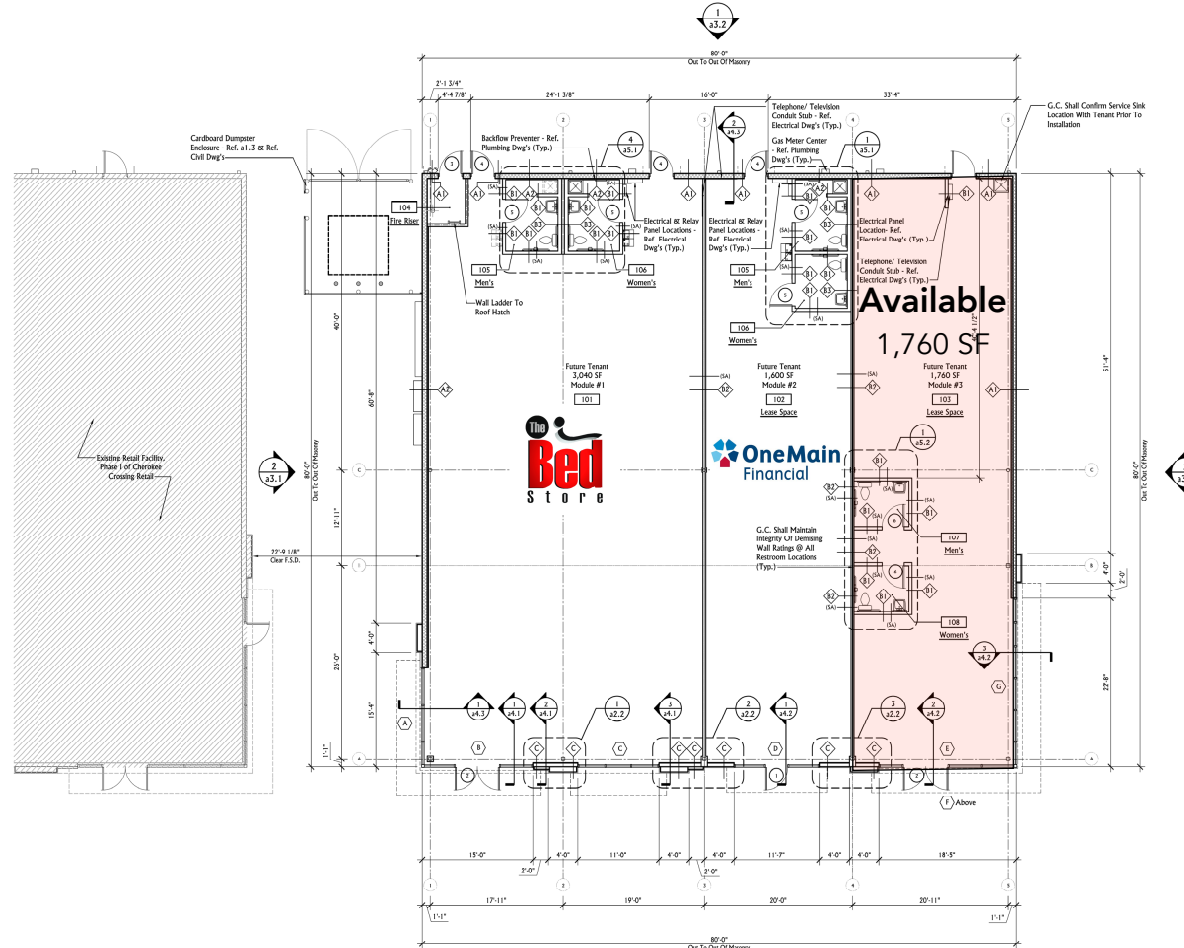

1 FLOOR PLAN
SCALE: 1/8" = 1'-0"

- Note: Extend Tenant Separation Wall to Front Wall.
- Note: G.C. Shall Coordinate Module #3 Tenant Plumbing Installation w/ Owner/Tenant Prior To Slab Pour.

A New Retail Facility:
Cherokee Crossing Phase II
140 Hatfield Drive
Morristown, TN 37814