

TYPICAL FIRE PENETRATION SIGNAGE:

FIRE AND SMOKE BARRIER, PROTECT ALL OPENINGS

GENERAL NOTES:

- EACH NEW/EXISTING FIRE WALL, FIRE BARRIER, FIRE PARTITION, SMOKE BARRIER, SMOKE PARTITION OR ANY MEMBRANE WALL REQUIRED TO HAVE PROTECTED OPENINGS SHALL BE EFFECTIVELY AND PERMANENTLY IDENTIFIED WITH SIGNS OR STENCILING ABOVE ANY DECORATIVE CEILING AND IN ALL CONCEALED SPACES WITH THE WORDING "FIRE AND SMOKE BARRIER - PROTECT ALL OPENINGS" OR SIMILAR LANGUAGE. SIGN BOARD OR STENCILING SHALL BE PROVIDED WITH 48 IN. HIGH LETTERS, AND IN STRIKE, AND NOT MORE THAN 15 FEET ON CENTER. SIGN BOARD OR STENCILING SHALL BE PROVIDED WITH RED LETTERING AND PROVIDED ON BOTH SIDES OF SAID ASSEMBLIES.

KEY NOTES	NOTES
<ol style="list-style-type: none"> MAXIMUM DIFFERENCE IN FLOOR ELEVATION ON BOTH SIDES OF ALL EXTERIOR DOORS TO REMAIN AT 2' MAX. IN ACCORDANCE WITH THE CODE, TYP. 8'-0" CLEAR AREA IN FRONT OF ELECTRICAL PANELS NOT USED. NOT USED. WALK-IN COOLER 	<p>PER THE 2012 INTERNATIONAL FIRE CODE SECTION 903.4, A FACILE SIGN STATING EXIT AND COMPLYING WITH ICC A117.1 RATED LETTERING AND SYMBOLS IS TO BE PROVIDED ADJACENT TO EACH DOOR TO AN EGRESS STARWAY, AN EXIT PASSAGEWAY, THE EXIT DISCHARGE AREA OF RESIDE, AND EXTERIOR AREA FOR ASSISTED RESCUE. SIGNS SHALL BE PLACED ON THE 1/2 WALL ON THE LATCH SIDE OF THE DOOR, 48 TO 60 INCHES OFF OF THE FLOOR.</p>

FIRE EXTINGUISHER ANALYSIS

- CLASSIFICATION OF HAZARD - (NFPA 10 SECTION 1-8)
 - LIGHT FLAMMABLE HAZARD (NFPA 10 SECTION 1-8.2) + 2A
 - MINIMUM RATED SINGLE EXTINGUISHER (NFPA 10 TABLE 3-2.1) + 5000 SF
 - MAXIMUM FLOOR AREA PER UNIT OF A (NFPA 10 TABLE 3-2.1) + 11250 SF
 - MAXIMUM FLOOR AREA FOR EXTINGUISHER (NFPA 10 TABLE 3-2.1) + 11250 SF
 - MAXIMUM TRAVEL DISTANCE TO EXTINGUISHER (NFPA 10 TABLE 3-2.1) + 75 FEET
- FIRE EXTINGUISHER SPECIFICATION

MANUFACTURER:	LARSEN
SERIES:	MF-DRY-CHEM
MODEL NO.:	MF5 5L RATING 2A-10BC
BRACKET:	PROVIDE RECESSED CABINET

LIFE SAFETY PLAN LEGEND

OCUPANCY LOAD FACTOR PER CODE	OCUPANCY CLASSIFICATION
000	FLOOR AREA
1000	TOTAL OCCUPANTS FOR THIS SPACE

Available
1,760 SF

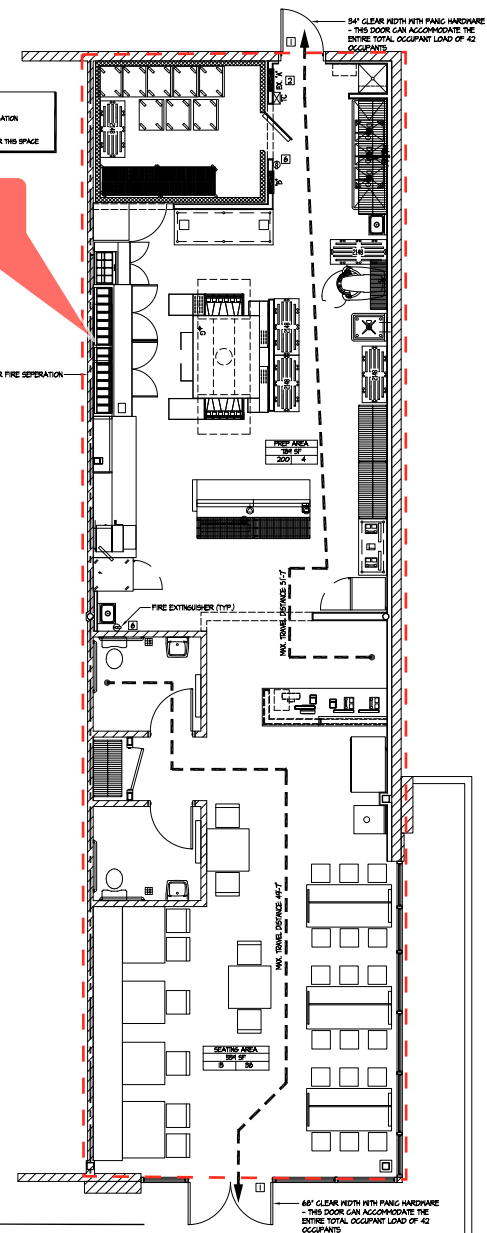

ACCESSORY MOUNTING LOCATIONS

TOILET FIXTURES

SIGNAGE

1 LIFE SAFETY PLAN
1/16" = 1'-0"



GERALD P. NOE ARCHITECT
TENNESSEE REG. NO. 102907

399 LUCERNE DRIVE
SPARTANBURG, SC 29302
P: 864.583.2215 F: 864.583.22
mail@gpnaarcht.com

CHECKED BY: DKH
DRAWN BY: LMP, DKH

THIS DRAWING IS AN INSTRUMENT OF SERVICE AND SOLE PROPERTY OF THE ARCHITECT, AND SHALL NOT BE USED IN ANY MANNER WHATSOEVER WITHOUT THE WRITTEN PERMISSION OF THE ARCHITECT. IT SHALL BE RETURNED TO THE ARCHITECT UPON DEMAND. COPYRIGHT 2018 ALL RIGHTS RESERVED

DATE: 02-08-20

REVISIONS:

NO.	DATE	DESCRIPTION	BY

CLIENT NAME:
EIGHT SLICE, LLC.

BRAD DAVIS
PO BOX 23350
KNOXVILLE, TENNESSEE 37933

PROJECT NAME:
marcos INTERIO UP-FIT
Pizza
CHEROKEE CROSSING
4313 WINKLER AVENUE - SUITE 3
MORRISTOWN, TENNESSEE 37814

SHEET TITLE:
LIFE SAFETY PLAN

PROJECT NUMBER 17-A146
DATE 02-08-2018
SHEET NO.

G-2